

BISHOPS CORNER

333 North Main Street, West Hartford, CT 06117

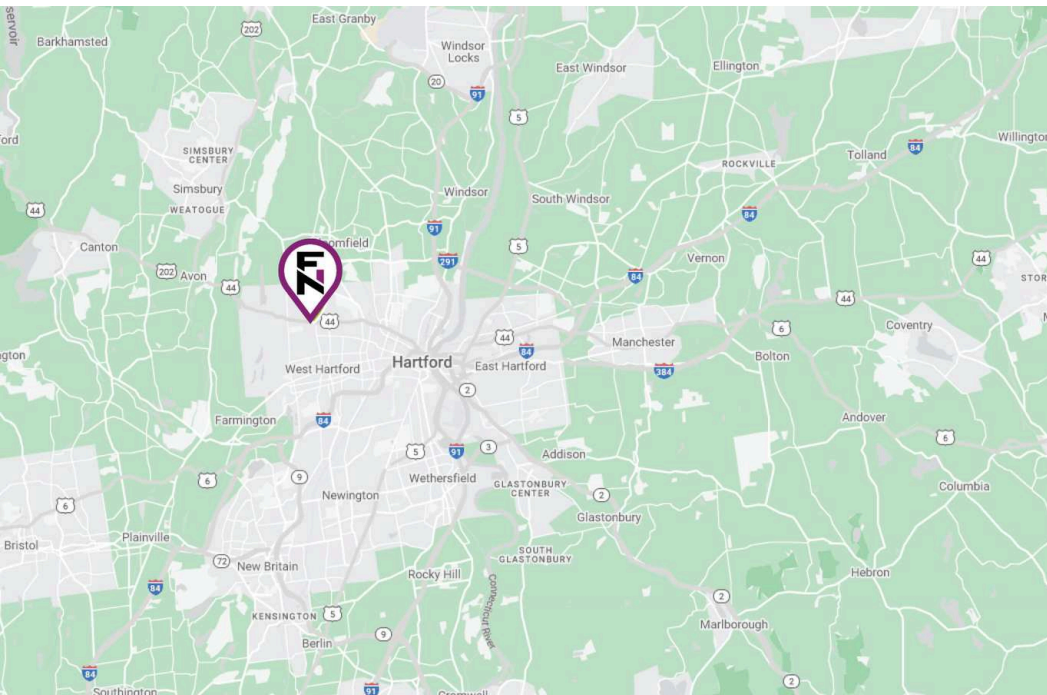

HIGHLIGHTS

MSA	Hartford-West Hartford-East Hartford, CT
COUNTY	Hartford
GLA	258,813
ACRES	14.51
PARKING	785

DEMOGRAPHICS

	1 Mile	3 Mile	5 Mile
	9,650	88,149	213,751
	3,823	36,726	86,644
	\$209,220	\$143,792	\$114,091

PROPERTY FEATURES

- Bishops Corner is a 258,813 SF vibrant and pedestrian-friendly shopping center anchored by a 59,364 SF Target.
- Originally built in 1970 and thoughtfully renovated in 2011, Bishops Corner is an upscale community place, keeping with the local charm and vitality of West Hartford.
- Major retailers: Target, Marshalls / Homegoods, TD Bank, The Paper Store, Mattress Firm, Orange Theory, AT&T, Bank of America, Noodles & Company, GNC, Subway & Massage Envy.
- Situated in a densely populated, highly affluent retail corridor approximately 4 miles west of downtown Hartford.
- The property sits at a signalized intersection along the region's dominant east-west thoroughfare which sees combined traffic counts of over 40,000 VPD.
- Within a 5-mile radius of the property, the population is over 213,000 people and within a 1-mile radius of the property, the average household income is more than \$209,000.



PROPERTY
WEBSITE

Candace Gschwind | 513-292-2652 | cgschwind@fnrpusa.com

fnrpusa.com

BISHOPS CORNER

333 North Main Street, West Hartford, CT 06117

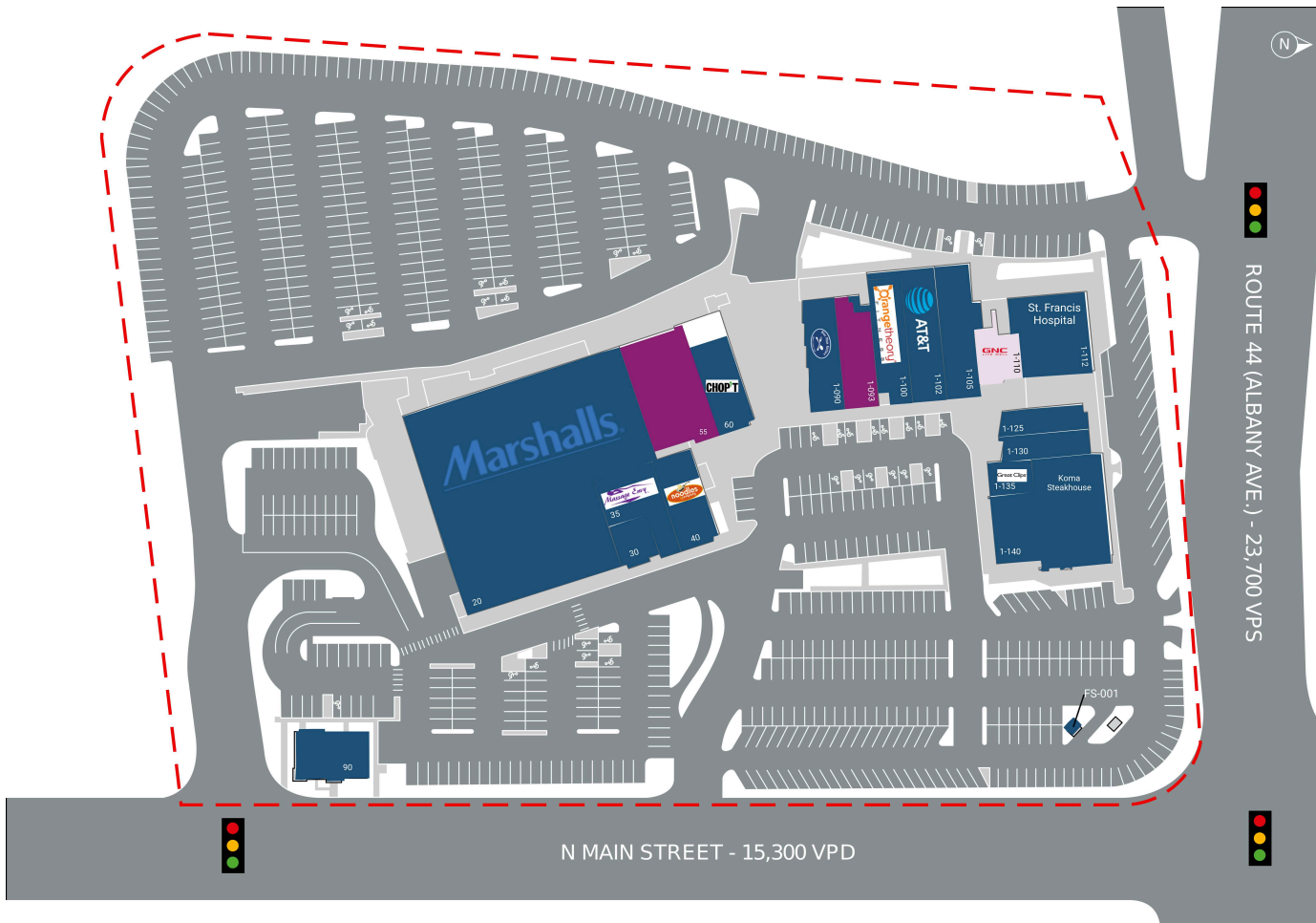

SUITE	TENANT NAME	SF
FS-001	Bank of America	1,200
1-090	Blue Plate Kitchen	2,950
1-093	Available	2,785
1-100	Orangetheory Fitness	3,443
1-102	AT&T	3,762
1-105	Restore Hyper Wellness + Cryot	3,604
1-110	GNC	1,918
1-112	St. Francis Hospital	4,647
1-125	Harvey & Lewis Opticians	1,700
1-130	Silk Nails	1,760
1-135	Great Clips	961
1-140	Koma Steakhouse	8,513
20	Marshalls	37,672
30	Poke City	1,490
35	Massage Envy	3,319
40	Noodles & Company	2,773
55	Available	6,457
60	Chop't Creative Salad Company	2,703
90	TD Bank	2,848

AVAILABLE
 AVAILABLE SOON
 LEASED
 NAP (NOT A PART)



PROPERTY
WEBSITE

Candace Gschwind | 513-292-2652 | cgschwind@fnrpusa.com

fnrpusa.com

BISHOPS CORNER

333 North Main Street, West Hartford, CT 06117

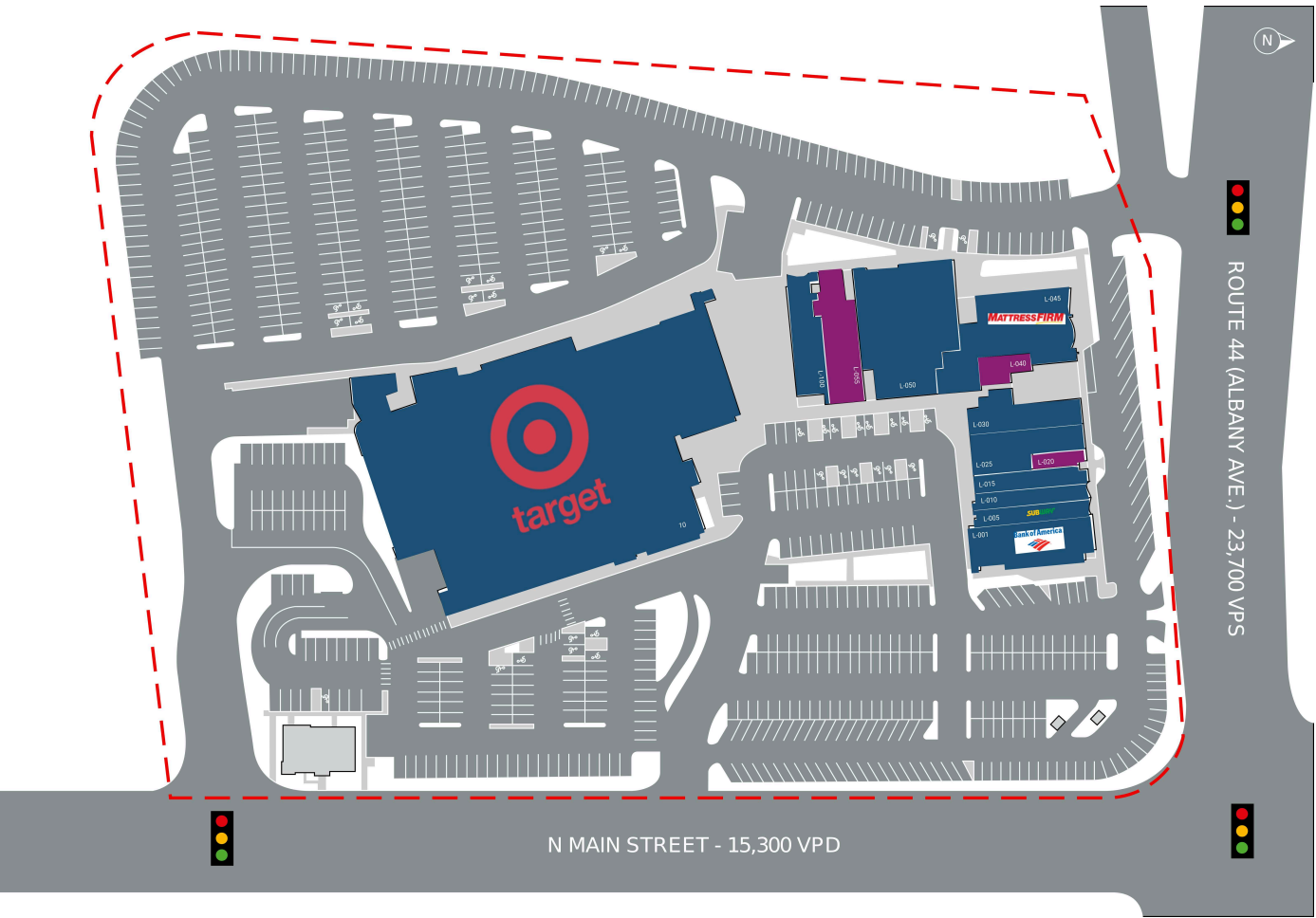

SUITE	TENANT NAME	SF
L-001	Bank of America	4,000
L-005	Subway	1,500
L-010	Nautical Bowls	1,400
L-015	European Wax Center	1,600
L-020	Available	667
L-025	West Hartford Podiatry	2,895
L-030	IVX Health	2,618
L-040	Available	1,142
L-045	Mattress Firm	6,110
L-050	Paper Store	9,774
L-055	Available	3,500
L-100	Float Forty One	3,213
10	Target	59,364

 AVAILABLE  AVAILABLE SOON  LEASED  NAP (NOT A PART)



PROPERTY
WEBSITE

Candace Gschwind | 513-292-2652 | cgschwind@fnrpusa.com

fnrpusa.com

BISHOPS CORNER

333 North Main Street, West Hartford, CT 06117

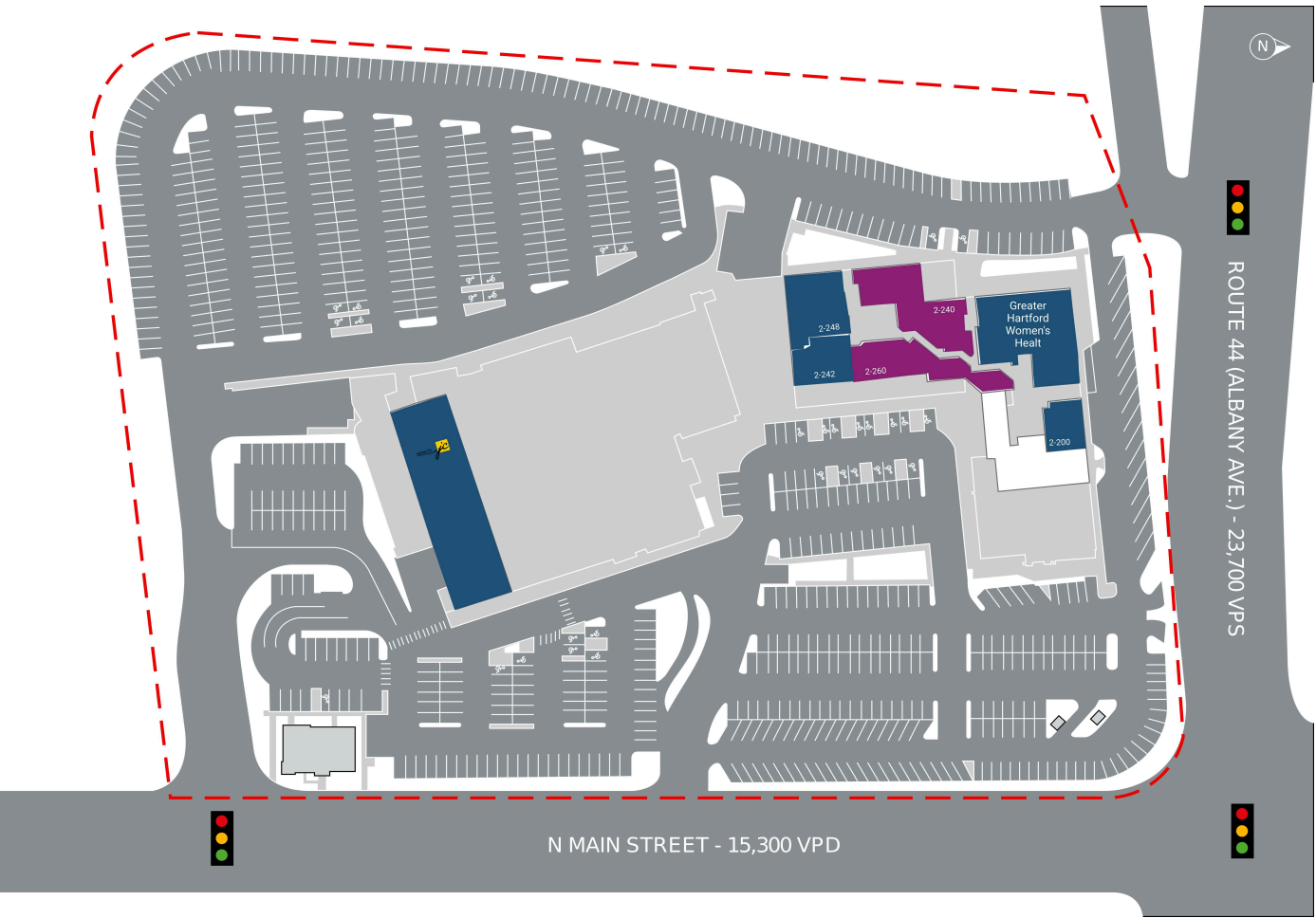

SUITE	TENANT NAME	SF
2-200	GP Urology	5,171
2-201	Greater Hartford Women's Health	8,609
2-240	Available	4,723
2-242	Connecticut Women OB/GYN	2,358
2-248	Pedicorp PC	3,500
2-260	Available	4,182
50	Salons by JC	10,000

■ AVAILABLE ■ AVAILABLE SOON ■ LEASED ■ NAP (NOT A PART)



PROPERTY
WEBSITE

Candace Gschwind | 513-292-2652 | cgschwind@fnrpusa.com

fnrpusa.com

BISHOPS CORNER

333 North Main Street, West Hartford, CT 06117

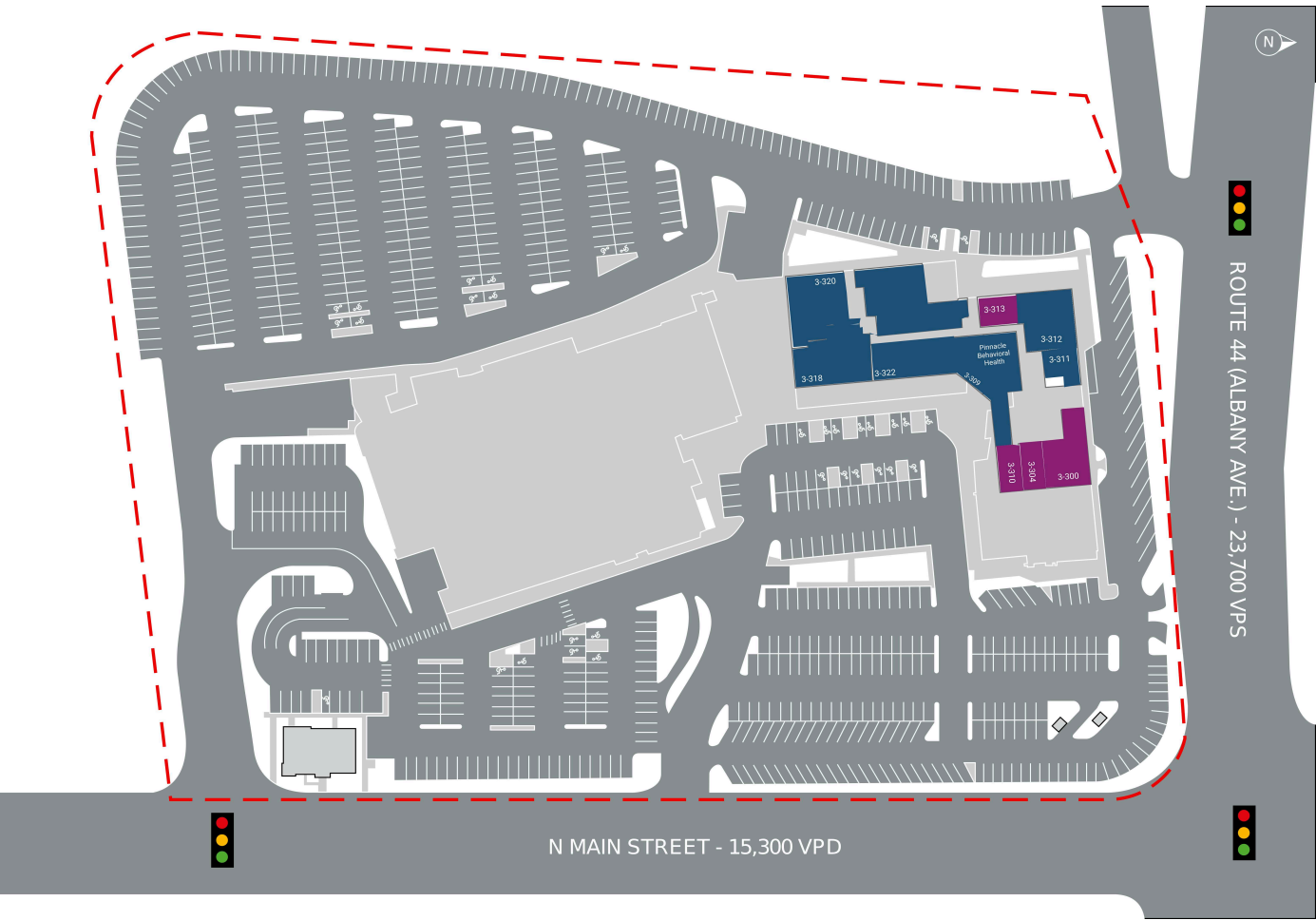

SUITE	TENANT NAME	SF
3-300	Available	2,727
3-304	Available	1,042
3-309	Pinnacle Behavioral Health	4,121
3-310	Available	860
3-311	Connecticut Psychiatric Partners	1,243
3-312	West Hartford Orthodontics	
3-313	Available	1,039
3-318	Regional Cancer Care Associate	8,518
3-320	Epstein & Rappoport, PC	5,602
3-322	West Hartford Chiropractic	2,483

■ AVAILABLE ■ AVAILABLE SOON ■ LEASED ■ NAP (NOT A PART)



PROPERTY
WEBSITE

Candace Gschwind | 513-292-2652 | cgschwind@fnrpusa.com

fnrpusa.com

333 North Main Street, West Hartford, CT 06117

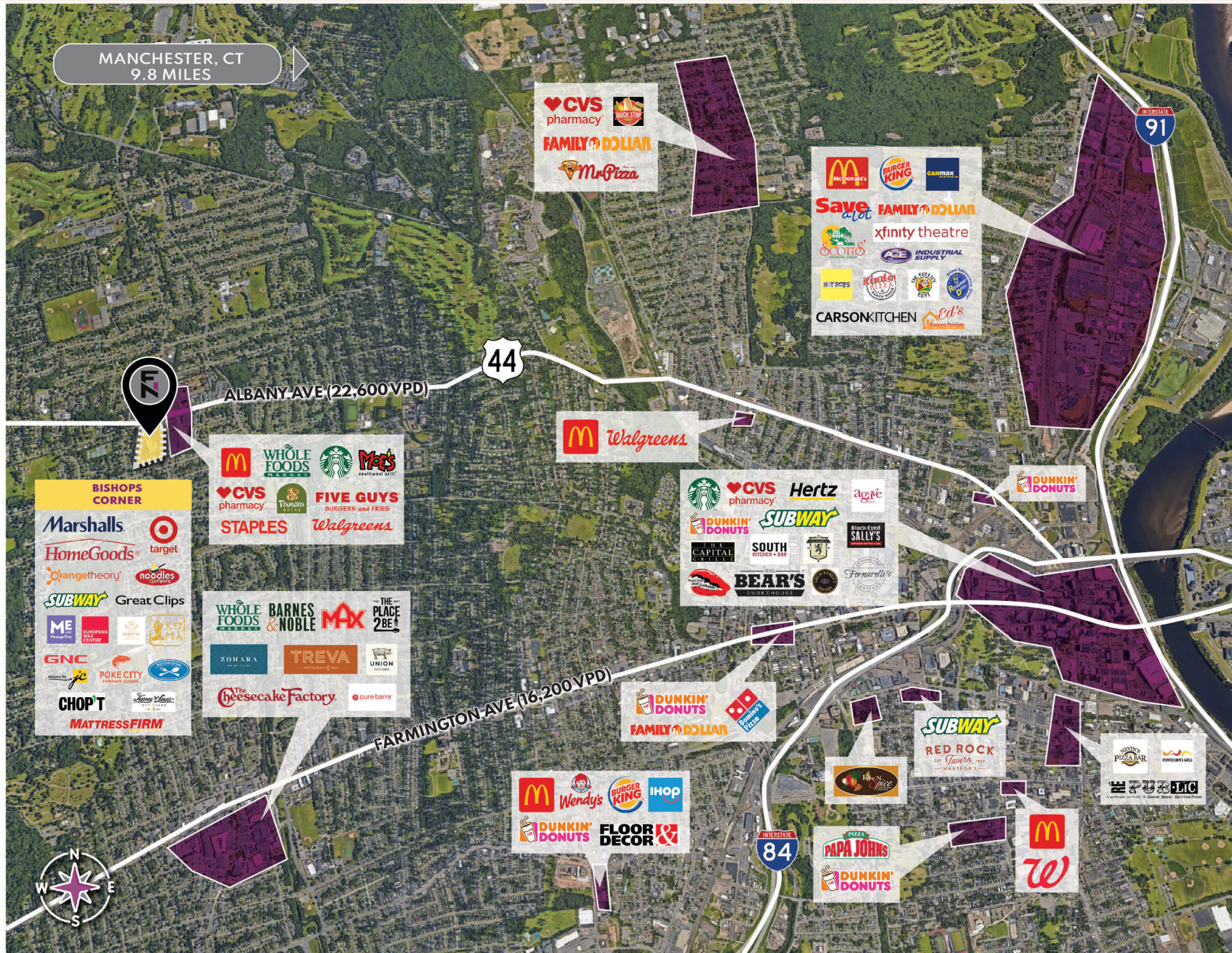

fnrpusa.com